

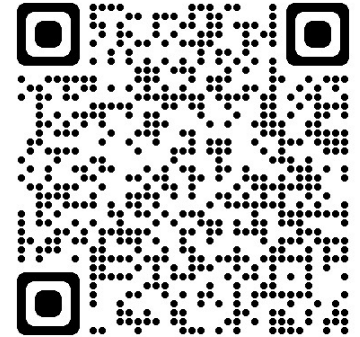

CITY OF EDMONDS
NOTICE OF APPLICATION AND COMMENT
PERIOD



NAME OF APPLICANT: Village Life, Inc
DATE OF APPLICATION: 2/22/2024
DATE OF COMPLETENESS: 4/8/2024
DATE OF NOTICE: 4/19/2024
FILE NO.: PLN2024-0015
PROJECT LOCATION: 8514 Bowdoin Way, Edmonds, WA
PROJECT DESCRIPTION: Application for a Preliminary 2-lot Short-Plat Subdivision. The site is zoned Single-Family Residential (RS-8).
REQUESTED PERMIT: Preliminary Short-Plat Subdivision Permit – Type II staff decision. Information on this development application can be obtained online at https://www.edmondswa.gov/services/public_involvement/public_notices/development_notices under the development notice for application number PLN2024-0015, by emailing the City contact listed below, or by calling the City of Edmonds at 425-771-0220. Please refer to the application number for all inquiries.
OTHER REQUIRED PERMITS: ENG2024-0157, Sewer Availability; ENG2024-0159 Water Availability
REQUIRED STUDIES: N/A
EXISTING ENVIRONMENTAL DOCUMENTS: CRA2024-0015
COMMENT PERIOD: **Comments due by May 3, 2024.** Any person has the right to comment on this application during the public comment period, receive notice and participate in any hearings, and request a copy of the decision on the application. The city may accept public comments at any time prior to the closing of the record of an open record pre-decision hearing, if any, or, if no open record pre-decision hearing is provided, prior to the decision on the project permit. Only parties of record as defined in ECDC 20.06.020 have standing to initiate an administrative appeal.
CITY CONTACT: Rose Haas, Planner
rose.haas@edmondswa.gov
PUBLISH: 04/19/2024



City of Edmonds Zoning and Vicinity Map

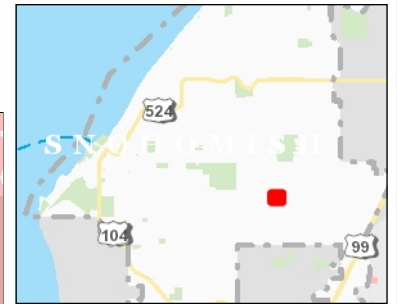
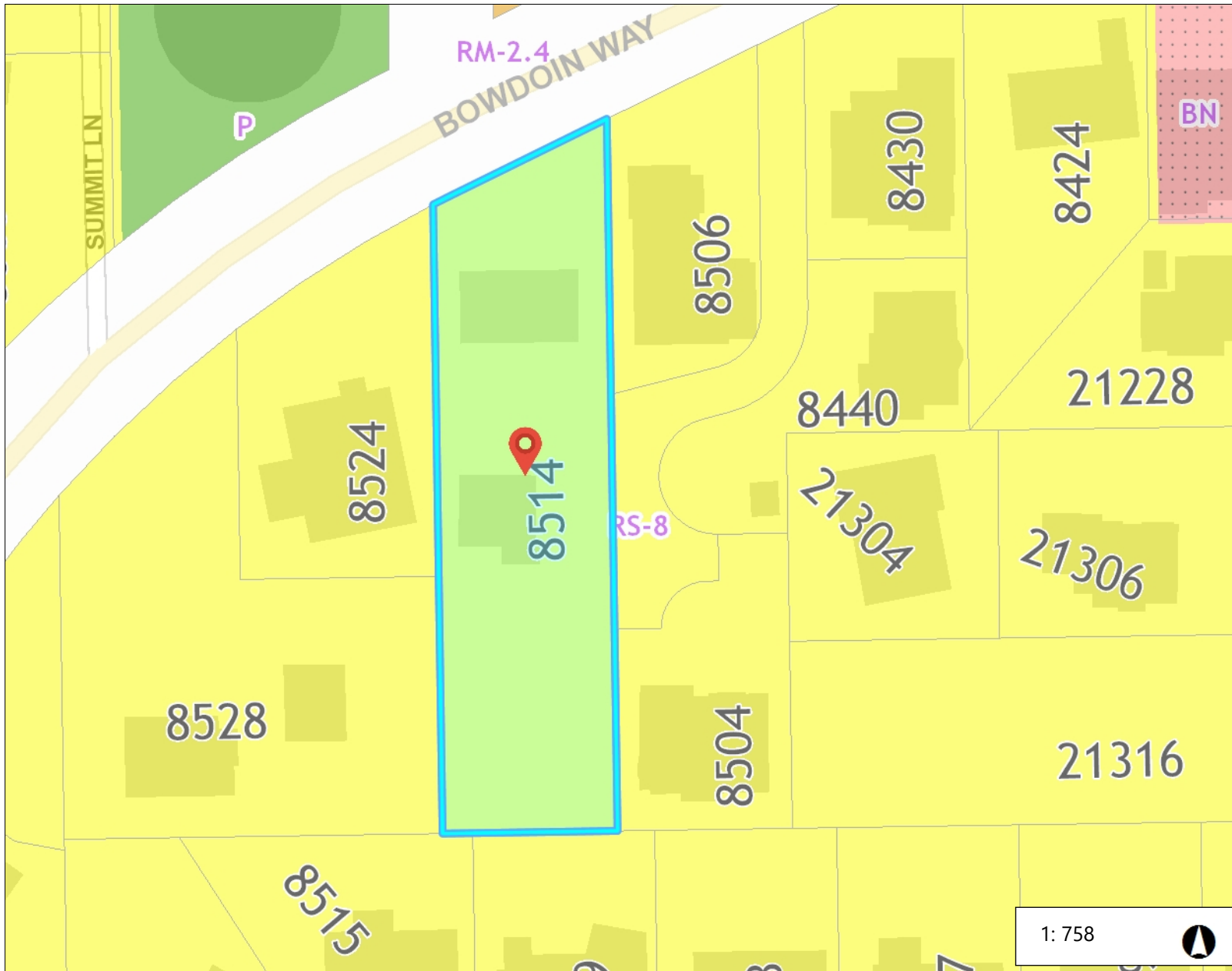

Legend

- ReZones
- PRD
- RoW**
- Zoning**
- RS-6
- RS-8
- RS-10
- RS-12
- RSW-12
- RS-20
- RS-MP
- RM-3
- RM-2.4
- RM-1.5
- RM-EW
- BD1
- BD2
- BD3
- BD4
- BD5
- OR
- WMU
- BP
- BN
- FVMU
- BC

1: 758

0 63.15 126.3 Feet

WGS_1984_Web_Mercator_Auxiliary_Sphere
© City of Edmonds

1,128 94.0

This map is a user generated static output from an Internet mapping site and is for reference only. Data layers that appear on this map may or may not be accurate, current, or otherwise reliable.

THIS MAP IS NOT TO BE USED FOR DESIGN OR CONSTRUCTION

Notes

8514 Bowdoin Way